

# HINO

## 500 Series

# FM 2628



\* Illustration may contain items not standard to the model

**ADR 80/03 Model**  
**6 x 4 Cab Chassis**

## KEY FEATURES

- Vehicle Stability Control (VSC) with ASR
- Polished Aluminium Wheels
- Cruise Control
- Reverse Camera
- Drivers SRS Airbag
- Heated & Electrically Operated External Mirrors
- ISRI 6860/870 Drivers seat with integrated Safety Belt
- ECE R-29 Cab Strength Certified
- Differential Cross Locks
- Hino Connect Telematics

## KEY SPECIFICATIONS

<b>GVM.</b>	26,000kg
<b>GCM.</b>	33,000kg
<b>Power</b>	280hp/206kW
<b>Torque</b>	883Nm
<b>Transmissions</b>	Six-speed Allison Automatic
<b>Nominal Wheelbases</b>	4.2m, 5.3m, 6.5m
<b>Max. Nominal Body Length*</b>	5.8m, 7.5m, 9.3m

ENGINE

Model	J08E-WA
Max. Output (ISO Net)	280hp/206kW @ 2,500 RPM
Max. Torque (ISO Net)	883Nm/90kgfm @ 1,500 RPM
Max. Engine Speed	2,700 RPM
Engine Compliance	ADR 80/03 using Euro 5 STD
Type	Turbocharged & Intercooled, 6 cylinder in-line, overhead camshaft & fluid cooled
Combustion System	Direct Injection
Bore & Stroke	112 x 130mm
Piston Displacement	7.687L
Compression Ratio	18.0:1
Engine Oil Capacity	13.5L
Coolant Fluid Capacity	Auto: 25L
Fuel Injection System	Electronic control common-rail type
Air Intake System	Stack-type
Air Cleaner	Dual paper elements
Air Compressor	Single cylinder, fluid cooled
	85 x 60mm (except XXL Leaf) 85 x 40mm (XXL Leaf)
Fan Clutch	Equipped
Exhaust	Horizontal
Emission Control System	Selective Catalytic Reduction (SCR)
Engine Immobilizer	Equipped

TRANSMISSION & GEAR RATIOS

Make & Description	Automatic	
	Allison 3500 series 6 speed with Electronic Control	
Type	Double Overdrive	
Gear Ratios	1	4.593
	2	2.257
	3	1.535
	4	1.000
	5	0.749
	6	0.651
	Rev	4.999
Torque convertor & Ratio	TC 415	2.35

PERFORMANCE

Calculations based on 26.0 t GVM with 11R22.5 drive tyres		
Transmission	Automatic	
Wheelbase variants	Medium	L & XXL
Rear Axle Ratio	6.142	6.428
Engine RPM @ 100 km/h	2,100	2,200
Max theoretical speed (km/h)	128	122
Gradeability tan Θ (%) @ GVM	44.9	47.5
Speed limited to (km/h)	100	

BRAKES

Type	Full Air, dual circuit, "S"cam
Drum & Lining sizes Diameter x Width	Front : 410 x 150mm
	Rear : 410 x 220mm
Auto adjusters	Equipped
Vehicle Stability Control (VSC)	Equipped
Anti-lock Braking System (ABS)	Equipped
Anti-Slip Regulator (ASR)	Equipped
Air Dryer	Equipped
Park Brake	Spring Brake acting on FA & FR axles
Exhaust Brake	Equipped

AXLE, SUSPENSION & LOAD LIMITS

FRONT	Front Axle Model	MF 78IR		
	Type	I-Beam, Reverse Elliot		
	Suspension	Taper leaf springs with shock absorbers		
	Spring Dimensions Length x Width x Thickness x Number	1,700 x 90 x 28.8 mm x 1 1,700 x 70 x 30.3 mm x 1		
	Spring Rate	32.8 kgf/mm		
	Axle Limit (including suspension)	6,500 kg		
	Tyre Limit	6,900 kg		
	Rear Axle Model	THD17 & SH17		
REAR	Differential Cross Lock	Equipped FR & RR		
	Inter-axle Differential Lock	Equipped		
	Type	Fully floating, single reduction, hypoid		
	Rear suspension types	Hino 6 Rod Leaf		Hendrickson Air
	Suspension	Semi-elliptic Multi Leaf		HAS 460 airbag with double acting shock absorbers and ECAS remote height control system
		Medium	Long & XXLlong	
	Spring Dimensions Length x Width x Thickness x Number	1,350 x 90 x 20 x 10	1,350 x 90 x 20 x 6 1,350 x 90 x 18 x 3	
	Spring Rate	293.4 kgf/mm	234.0 kgf/mm	Road Friendly Suspension Rating N/o 2005
	Axle Limit (including suspension)	20,000 kg		
	Tyre Limit	21,800 kg		

WHEELS & TYRES

Material	Polished Aluminium
Wheel type	10-stud disc (ISO) 335 PCD
Rim size (in)	22.5 x 8.25 – 165mm offset
Tyre size	Front: 295/80R22.5 152/148
	Rear: 11R22.5 148/145
Number of tyres	11
Spare Tyre Carrier	Equipped (except Medium Wheel Base)

FUEL TANK

Wheelbases	Medium	Long & XXLlong
Material	Steel	Aluminium
Capacity	200L	390L
Lockable cap	Equipped	
Pre Filter & sedimenter	Equipped	
AdBlue® tank capacity	59L	

STEERING

Type	Telescopic & tilt steering column with locking device. Recirculating ball with internal Power Steering
Steering Angles	Inner 49°
	Outer 34°

CAB DETAILS

Type	Forward control, all-steel construction mounted on full floating coil spring suspension with electro hydraulic tilt mechanism
ECE R-29 Cab strength	Compliant
Drivers SRS Airbag	Equipped
Seating capacity	Three
Driver's seat	ISRI 6860/870 with urethane foam pads, high-back, lumbar support, multi adjustable, air suspended, with integrated safety belt
Side passenger's seat	Urethane foam pads, high-back & reclining seat with fabric cover, air suspension
Centre passenger's seat	Urethane foam pads & foldaway type with seat back tray, fabric cover
Seat belt	3-point type on driver's & side passenger's seat 2-point type on centre passenger seat
Sun visor and overhead console	For driver & passenger sides
Windshield wipers	Electric, dual, intermittent & 2-speed
Ventilator	Forced type by electric blower
Rear view mirrors	External: Electric Control & heated flat type, Convex spotters both sides and Left side kerb view
12V/120w Socket	Equipped
Floor mat	Vinyl type
Central locking & keyless entry	Equipped with immobiliser
Heater and defroster	Standard
Air conditioner	Standard
Trim	Full trim type (side, roof & back)
Cab pockets	Equipped on both door sides
Power windows	Equipped
Rest area	Equipped
Multi media system	10.1" UXGA capacity touch screen, wireless Apple CarPlay and Android auto compatible, AM/FM+RDS/DAB + radio, Bluetooth 5.0 phone and audio, input for up to 6 cameras, USB 2.0 and 3.0, 2.4 Ghz Wi-Fi enabled
Speakers	Driver & passenger
Foot rest	Equipped
Cup holders	Equipped
Cruise control	Equipped
Reverse camera	Equipped

ELECTRICAL

Type	24V, negative earth
Batteries	12V x 2, series connection, 120 Ah
Alternator Type	Brushless, with built-in regulator
Capacity	24V, 90 Amp
Starter Type	24V, 5.0 kW
Headlamps	Halogen type with manual levelling
High/low beam	Equipped
LED Fog Lamps (white)	Equipped
Fluorescent Reading Lamp	Equipped
Electric air horn	Equipped

POWER & TORQUE CHART (ISO NET) J08E-WA

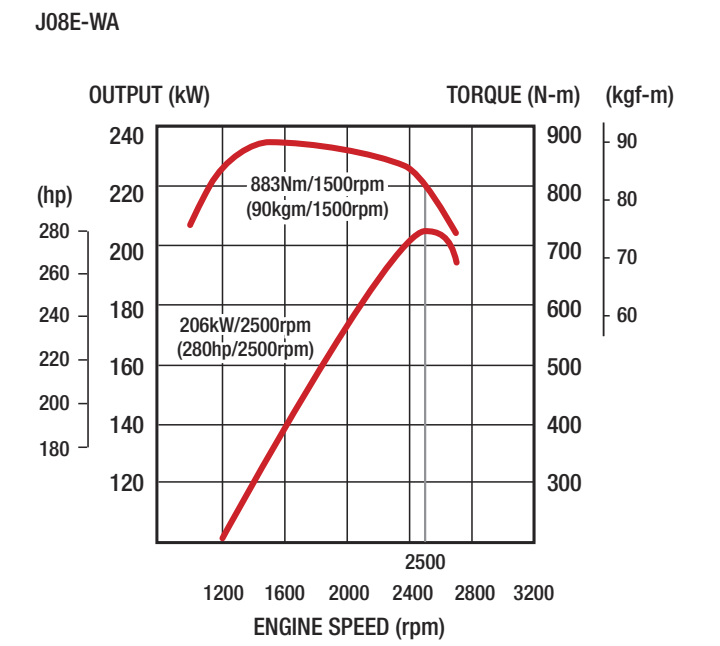

INSTRUMENTS

<b>Meters</b>	<b>Additional Switches &amp; Controls</b>
Speedometer	External flat mirror Control
Tachometer	Idle up Control
<b>LCD Gauges</b>	Quick warm up switch
Air pressure (2)	VSC/ASR off switch
Fuel	Headlight Levelling
AdBlue®	Fog Lamp
Engine Temperature	ECAS remote (air bag models)
Odometer plus trip meter	Inter-axle & Differential Cross Locks
<b>Multi Information Display (MID)</b>	
Fuel Consumption	
Service reminders	
Warnings	
Faults	

CHASSIS FRAME

Wheelbase variants	Medium & Long	XXLong
Type	Ladder-shaped channel section side rails with Grid hole design	
Chassis outer width (at rear)	840mm	
Main section (mm) Depth x flange x Thickness)	298 x 80 x 7.0	300 x 80 x 8.0
Tensile strength	620 N/mm <sup>2</sup> (63 kgf/mm <sup>2</sup> )	
Front Underrun Protection (FUP)	Equipped	
Front and rear tow hook	Equipped	

GENUINE ACCESSORY OPTIONS

Bull bar	GPS Satellite Navigation
Stoneguard	Cameras (up to additional 5 extra)
Sunvisor	Lane change Assist Cameras
Seat covers	DVR
Floor mats	Engine driven PTO
Dash mats	1:0.72 step-down
Weather shields	or 1:1.08 step-up

Please check with your dealer for price, availability & fitment for these options

# FM 2628

**500 Series**

## DIMENSIONS – MM/CAPACITIES

Model	FM 2628					
Wheelbase variant	MEDIUM		LONG		XX LONG	
Transmission	AUTO				AUTO	
Rear Suspension	LEAF	AIR	LEAF	AIR	LEAF	AIR
Model Code	FM8JL1M-WHU	FM8JL1U-WHU	FM8JR1A-WHU	FM8JR1G-WHU	FM8JW1A-WHU	FM8JW1G-WHU
Wheelbase (WB)	4,255	4,260	5,305	5,310	6,505	6,510
Axle Spread (AS)	1,350	1,330	1,350	1,330	1,350	1,330
Max Nominal Body length # (WB x 0.6 (up to 3.7)) + CA – 80)	5,773	5,781	7,578	7,586	9,295	9,300
Overall Length (OL)	7,845		9,295		11,245	
Overall Width (OW)	2,490					
Overall Height (OH)	2,755		2,750		2,750	
Cab to Rear Axle Centre (CA)	3,300	3,305	4,475	4,480	5,675	5,680
Front Overhang (FOH)	1,280					
Rear Overhang (ROH)	2,250	2,245	2,650	2,645	3,400	3,395
Front Chassis Height (FCH)	1,030		1,025		1,025	
Rear Chassis Height (RCH)	1,070	1,045	1,070	1,045	1,070	1,045
Road Clearance (RC)	250					
Front Track (FT)	2,050					
Rear Track (RT)	1,855	1,840	1,855	1,840	1,855	1,840
Turning Circle Kerb to Kerb	15,600	15,800	19,000		22,600	
Wall to Wall	17,200	17,400	20,600		24,200	
Indicative Chassis Mass – kg (10 litres of fuel & spare tyre and subject to ± 3% Tolerance)						
Total	7,202	6,754	7,273	6,883	7,473	7,088
Front	3,504	3,490	3,528	3,524	3,607	3,613
Rear	3,698	3,264	3,745	3,359	3,866	3,475
GVM	26,000					
GCM	33,000					

# ROH may need to be extended to suit body length and rear overhang is limited to 3.7m

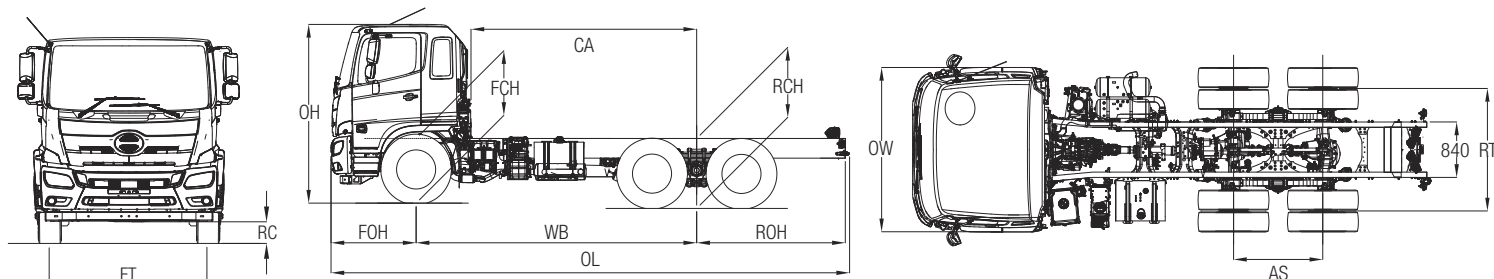

## WARRANTY

New vehicle warranty period

Medium Duty Model	Axle configuration	Standard warranty (whichever comes first)	Cab corrosion perforation
500 FM 2628	6 x 4	3 years or 200,000km	36 months

Battery warranty – 12 months from date of delivery

Genuine parts or accessories warranty – 3 years unlimited kilometres when fitted by an authorised Hino dealer \*

\* For conditions, refer to the Hino Parts & Service warranty brochure



## DISCLAIMER

Important notice. Hino Trucks are distributed in Australia by Hino Motor Sales Australia Pty Ltd A.C.N. 064 989 724. All efforts have been made to ensure the information contained in this brochure was correct at time of printing or uploading. Hino Motor Sales Australia Pty Ltd reserves the right to alter any details of the specifications & equipment without notice. Hino in so far as it is permitted by law to do so, shall not be liable in any way as a result of any reliance placed by any person on anything contained in this brochure. You should therefore check with your authorised Hino dealer at the time of ordering your motor vehicle to ensure that colour, specifications, equipment, design features & options are available for the vehicle you are ordering. Please note that some options may only be available in combination with others. Authorised Hino dealers will on request provide up to date information on all accessories, design features, prices & availability.