

HINO

500 Series

GH 1832 Auto GH 1835 Manual



* Illustration may contain items not standard to the model

ADR 80/03 Model 4 x 2 Cab Chassis

KEY FEATURES

- Vehicle Stability Control (VSC) with ASR
- Polished Aluminium Wheels
- Cruise Control
- Hino Stop Start System (HSS) (Manual models only)
- Engine Retarder Brake
- Reverse Camera
- Easy Start (ES) Take off assist (Manual models Only)
- Drivers SRS Airbag
- Heated & Electrically Operated External Mirrors
- ISRI 6860/870 Drivers seat with integrated Safety Belt
- ECE R-29 Cab Strength Certified
- Leaf and Air with ECAS Rear suspension variants
- Differential Cross Lock

KEY SPECIFICATIONS

Models	. GH 1832	. GH 1835
GVM	. 16,000kg Standard	. 16,000kg Standard
	. 18,000kg Optional	. 18,000kg Optional
GCM	. 38,000kg	. 38,000kg
Power	. 320hp/235kW	. 350hp/257kW
Torque	. 1,275Nm	. 1,422Nm
Transmissions	. Six-speed	. Nine-speed
	. Allison Automatic	. Synchromesh Manual
Nominal Wheelbases	. 5.4m, 6.0m, 6.3m	
Max. Nominal Body Length[#]	. 7.9m, 8.8m, 9.2m	

ENGINE

Model	GH 1832	GH 1835
Engine Model	A09C-US	A09C-UR
Max. Output (ISO Net) @ 1,800 RPM	320hp/235kW	350hp/257kW
Max. Torque (ISO Net) @ 1,100 RPM	1,275Nm	1,422Nm
Max. Engine Speed	2,100 RPM	
Engine Compliance	ADR 80/03 using Euro 5 STD	
Type	Turbocharged & Intercooled, 6 cylinder in-line, overhead camshaft & fluid cooled	
Combustion System	Direct Injection	
Bore & Stroke	112 x 150mm	
Piston Displacement	8.866L	
Compression Ratio	17.0:1	
Engine Oil Capacity	13.5L	
Coolant Fluid Capacity	Auto: 29.6L	
	Manual: 29.5L	
Fuel Injection System	Electronic control common-rail type	
Air Intake System	Stack-type	
Air Cleaner	Dual paper elements	
Air Compressor	Single cylinder, fluid cooled	
	85 x 60mm	
Fan Clutch	Equipped	
Exhaust	Horizontal	
Emission Control System	Selective Catalytic Reduction (SCR)	
Hino Stop Start System (HSSS)	Manual models only	
Engine Immobilizer	Equipped	

CLUTCH (MANUAL MODELS ONLY)

Model	CS-430
Type	Dry single plate with damper springs
Facing material	Organic
Facing outside diameter	430mm
Control	Hydraulic with air booster

TRANSMISSION & GEAR RATIOS

Make & Description	Automatic		Manual	
	Allison 3200 series 6 speed with Electronic Control		Hino M009 OD 9 speed with Cable Control	
Type	Double Overdrive		Over Drive	
Gear Ratios	1	3.487	1	10.178
	2	1.864	2	6.986
	3	1.409	3	5.063
	4	1.000	4	3.636
	5	0.750	5	2.633
	6	0.653	6	1.921
	Rev	5.027	7	1.392
			8	1.000
			9	0.724
		Rev	9.874	
Torque convertor & Ratio	TC 421	1.77		
Rear axle Ratio	5.428		4.875	

PERFORMANCE

Calculations based on 18.0 t GVM with 11R22.5 drive tyres		
Transmission	Automatic	Manual
Engine RPM @ 100 km/h	1,860	1,850
Max theoretical speed (km/h)	112	114
Gradeability tan θ (%) @ GVM	48	60
Speed limited to (km/h)	100	

BRAKES

Type	Full Air, dual circuit, "S"cam
Drum & Lining sizes	Front : 410 x 150mm
Diameter x Width	Rear : 410 x 220mm
Auto adjusters	Equipped
Vehicle Stability Control (VSC)	Equipped
Anti-lock Braking System (ABS)	Equipped
Anti-Slip Regulator (ASR)	Equipped
Air Dryer	Equipped
Easy Start (ES)	Manual models only
Park Brake	Spring Brake acting on rear wheels
Engine Retarder Brake	Equipped

AXLE, SUSPENSION & LOAD LIMITS

FRONT	Front Axle Model	MF 78IR		
	Type	I-Beam, Reverse Elliot		
	Suspension	Taper leaf springs with shock absorbers & stabiliser		
	Spring Dimensions Length x Width x Thickness x Number	1,700 x 90 x 28.8 mm x 1 1,700 x 70 x 30.3 mm x 1		
	Spring Rate	32.8 kgf/mm		
	Axle Limit (including suspension)	6,500 kg		
	Tyre Limit	6,900 kg		
	Rear Axle Model	SH17 for 1832	/	SH18 for 1835
	Differential Cross Lock	Equipped		
	Type	Fully floating, single reduction, hypoid		
REAR	Rear suspension types	Hino Multi Leaf	Hendrickson Air	
	Suspension	Semi-elliptic Multi Leaf	HAS 230 airbag with double acting shock absorbers and ECAS remote height control system	
		Main		Auxiliary
	Spring Dimensions Length x Width x Thickness x Number	1,500 x 90 x 14 x 9	1,000 x 90 x 12 x 6 1,000 x 90 x 13 x 2	
	Spring Rate	53.9 kgf/mm	102.1 kgf/mm	
	Axle Limit (including suspension)	11,500 kg		
	Tyre Limit	10,900 kg		
				Road Friendly Suspension Rating N/o 2005

WHEELS & TYRES

Material	Polished Aluminium
Wheel type	10-stud disc (ISO) 335 PCD
Rim size (in)	22.5 x 8.25
Tyre size	Front: 295/80R22.5 152/148 Rear: 11R22.5 148/145
Number of tyres	7
Spare Tyre Carrier	Equipped (Except for S & M wheelbase)

FUEL TANK

Material	Aluminium
Capacity	390L
Lockable cap	Equipped
Pre Filter & sedimenter	Equipped
AdBlue® tank capacity	59L

STEERING

Type	Telescopic & tilt steering column with locking device. Recirculating ball with internal Power Steering
Steering Angles	Inner 49°
	Outer 34°

CAB DETAILS

Type	Forward control, all-steel construction mounted on full floating coil spring suspension with electro hydraulic tilt mechanism
ECE R-29 Cab strength	Compliant
Drivers SRS Airbag	Equipped
Seating capacity	Three
Driver's seat	ISRI 6860/870 with urethane foam pads, high-back, lumbar support, multi adjustable, air suspended, with integrated safety belt
Side passenger's seat	Urethane foam pads, high-back & reclining seat with fabric cover, air suspension
Centre passenger's seat	Urethane foam pads & foldaway type with seat back tray, fabric cover
Seat belt	3-point type on driver's & side passenger's seat 2-point type on centre passenger seat
Sun visor and overhead console	For driver & passenger sides
Windshield wipers	Electric, dual, intermittent & 2-speed
Ventilator	Forced type by electric blower
Rear view mirrors	External: Electric Control & heated flat type, Convex spotters both sides and Left side kerb view
12V/120w Socket	Equipped
Floor mat	Vinyl type
Central locking & keyless entry	Equipped with immobiliser
Heater and defroster	Standard
Air conditioner	Standard
Trim	Full trim type (side, roof & back)
Cab pockets	Equipped on both door sides
Power windows	Equipped
Rest area	Equipped
Multi media system	6.5" LCD, HD touch screen display with DAB+ AM/FM radio, AAUX input, Bluetooth® 4.a, Android 6.0 CANBUS connection and Wi-Fi enabled
Speakers	Driver & passenger
Foot rest	Equipped
Easy Start	Manual Models only
Cup holders	Equipped
Cruise control	Equipped
Reverse camera	Equipped

ELECTRICAL

Type	24V, negative earth
Batteries	12V x 2, series connection, 120 Ah
Alternator Type	Brushless, with built-in regulator
Capacity	24V, 90 Amp
Starter Type	24V, 6.0 kW
Headlamps	Halogen type with manual levelling
High/low beam	Equipped
LED Fog Lamps (white)	Equipped
Fluorescent Reading Lamp	Equipped
Electric air horn	Equipped

POWER & TORQUE CHART (ISO NET) A09CUS & A09CUR

A09C-US/A09C-UR

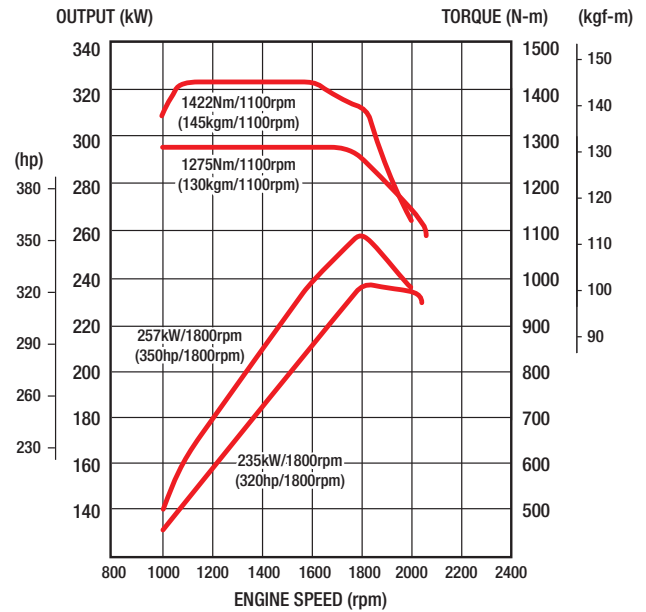

INSTRUMENTS

Meters	Additional Switches & Controls
Speedometer	External flat mirror Control
Tachometer	Easy Start Rate Control (Manual models only)
LCD Gauges	Idle up Control
Air pressure (2)	Quick warm up switch
Fuel	VSC/ASR off switch
AdBlue®	Hino Stop Start System off switch (Manual models only)
Engine Temperature	Eco Run (Manual models only)
Odometer plus trip meter	Headlight Levelling
Multi Information Display (MID)	Fog Lamp
Fuel Consumption	ECAS remote (air bag models)
Service reminders	Differential Cross Lock
Warnings	Engine Retarder Brake
Faults	

CHASSIS FRAME

Wheelbase variants	L	XL & XXL
Type	Ladder-shaped channel section side rails with Grid hole design	
Chassis outer width (at rear)	840mm	
Main section (mm)	275 x 80 x 7.0	277 x 80 x 8.0
Depth x flange x Thickness)		
Tensile strength	620 N/mm ² (63 kgf/mm ²)	
Front Underrun Protection (FUP)	Equipped	
Front and rear tow hook	Equipped	

GENUINE ACCESSORY OPTIONS

Bull bar	GPS Satellite Navigation
Stoneguard	External Vision Cameras (additional 3)
Sunvisor	LED Driving Lights
Seat covers	Hino Traq (Telematics)
Floor mats	Engine driven PTO
Dash mats	1:1 ratio
Weather shields	

Please check with your dealer for price, availability & fitment for these options

GH 1832 GH 1835

500 Series

DIMENSIONS – MM/CAPACITIES

Model	GH 1832			GH 1835		
Wheelbase variant	LONG	XLONG	XXLONG	LONG	XXLONG	XXLONG
Transmission	AUTO			MANUAL		
Suspension	AIR			AIR		LEAF
Model Code	GH1AN1G-RHU	GH1AS1G-RHU	GH1AT1G-RHU	GH1AN1G-SHU	GH1AT1G-SHU	GH1AT1A-SHU
Wheelbase (WB)	5,450	6,050	6,350	5,450	6,350	6,330
Max Nominal Body length # (WB x 0.6 (up to 3.7)) + CA – 80)	7,910	8,870	9,240	7,910	9,240	9,220
Overall Length (OL)	8,695	10,095	11,245	8,695	11,245	11,245
Overall Width (OW)	2,490					
Overall Height (OH)	2,900			2,900	2,895	2,900
Cab to Rear Axle Centre (CA)	4,720	5,320	5,620	4,720	5,620	5,600
Front Overhang (FOH)	1,380					
Rear Overhang (ROH)	1,805	2,605	3,455	1,805	3,455	3,475
Front Chassis Height (FCH)	995			995	900	995
Rear Chassis Height (RCH)	1,030			1,080		
Road Clearance (RC)	250					
Front Track (FT)	2,050					
Rear Track (RT)	1,835					
Turning Circle Kerb to Kerb	18,400	20,200	21,200	18,400	21,200	21,200
Wall to Wall	20,200	22,000	23,000	20,200	23,000	23,000
Indicative Chassis Mass – kg (10 litres of fuel & spare tyre and subject to ± 3% Tolerance)						
Total	5,832	5,967	6,047	5,953	6,163	6,328
Front	3,889	3,939	3,934	3,964	4,009	4,004
Rear	1,943	2,028	2,113	1,989	2,154	2,324
GVM	16,000kg Standard 18,000kg Optional					
GCM	38,000					

ROH may need to be extended to suit body length and rear overhang is limited to 3.7 m

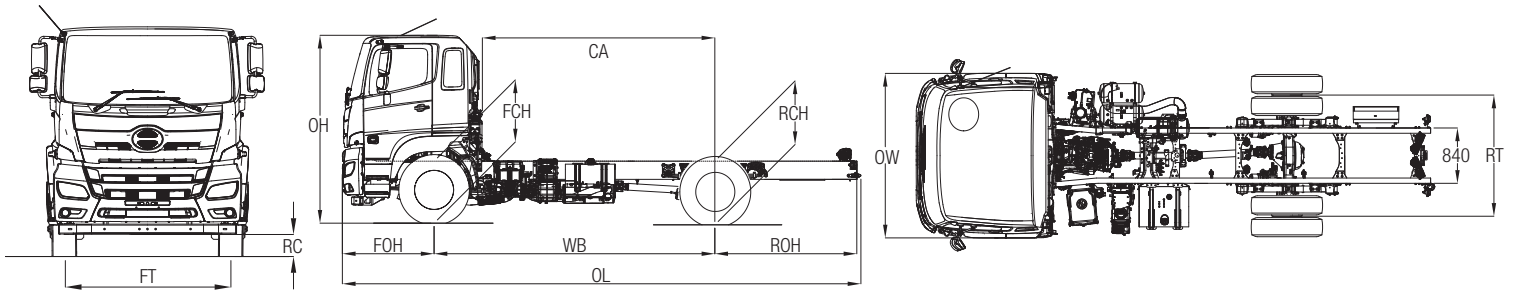

WARRANTY

New vehicle warranty period

Medium Duty Model	Axle configuration	Standard warranty (whichever comes first)	Cab corrosion perforation
500 GH 1832 & GH 1835	4 x 2	3 years or 200,000km	36 months

Battery warranty – 12 months from date of delivery

* For conditions, refer to the Hino Parts & Service warranty brochure

Genuine parts or accessories warranty – 3 years unlimited kilometres when fitted by an authorised Hino dealer *



DISCLAIMER

Important notice. Hino Trucks are distributed in Australia by Hino Motor Sales Australia Pty Ltd A.C.N. 064 989 724. All efforts have been made to ensure the information contained in this brochure was correct at time of printing or uploading. Hino Motor Sales Australia Pty Ltd reserves the right to alter any details of the specifications & equipment without notice. Hino in so far as it is permitted by law to do so, shall not be liable in any way as a result of any reliance placed by any person on anything contained in this brochure. You should therefore check with your authorised Hino dealer at the time of ordering your motor vehicle to ensure that colour, specifications, equipment, design features & options are available for the vehicle you are ordering. Please note that some options may only be available in combination with others. Authorised Hino dealers will on request provide up to date information on all accessories, design features, prices & availability.