

# HINO 300 Series

## Alloy Tray Range



\*Image may contain items not standard to the model

## KEY FEATURES

Aluminium Tray with drop sides  
STD Cab, Wide & Crew Cab variants  
Pre-Collision System (PCS) including AEB & PD  
Vehicle Stability Control (VSC) including ABS & TC  
Lane Departure Warning System (LDWS)  
Daytime Running Lamps (DRL)  
Dual SRS Airbags  
Reverse Camera  
ECE R-29 Cab Strength Certified  
Cruise Control\*\*  
ADR 80/03 Emission level using Euro 5 Standard

## KEY SPECIFICATIONS

**GVM.** . . . . . 4,499 to 6,500 kg  
**GCM.** . . . . . GVM + 3,500kg  
. . . . . 616 Automatic limited to 8,000kg  
**Power range** . . . . . 150hp to 205hp  
**Torque range** . . . . . 420Nm to 600Nm  
**Transmissions** . STD cab . 5 spd Manual & 6 spd Automatic  
. . . . . Wide cab . 6 spd Manual & 6 spd Automatic  
**Wheelbases** . . . . . 2.5m to 4.4m\*  
**Nominal Body Length** . . . . . 3.2m to 4.5m\*

\*See Model details for exact dimensions

MODEL DETAILS

Model Description		616 MT 2525 STD ALLOY TRAY	616 AT 2525 STD ALLOY TRAY	616 AT 3375 STD ALLOY TRAY	617 MT 2810 Wide ALLOY TRAY	616 AT 2810 Wide ALLOY TRAY
Product Code		XZU605R-WKMMSQ3 AL	XZU605R-WKTMSQ3 AL	XZU655R-WKTMSQ3 AL	XZU700R-WKFMTQ3 AL	XZU700R-WKTMSQ3 AL
ALLOY TRAY BODY DETAILS						
Internal length		3,080		4,435	3,535	
Internal width		1,800			2,055	
Floor rating		4 tonnes				
Rope rails		40 x 3 mm				
Drop sides per side		1		2	1	
Height of Drop sides & tailgate		257 mm			365 mm	
VEHICLE DETAILS						
Engine speed @ 100 Km/h		2,500rpm	2,230rpm		2,128rpm	2,165rpm
Max theoretical speed		124km/h	139km/h		145km/h	143km/h
Engine Power & Torque (HP & Nm)		150hp/420Nm			165hp/464Nm	150hp/420Nm
Transmission type & number of forward gears		Manual 5 speed	Automatic 6 speed		Manual 6 speed	Automatic 6 speed
Fuel Tank Capacity		80 L		100 L		
Wheels & Tyres		185/85R16			195/85R16	
Seating capacity		3				
DIMENSIONS – (MM)/WEIGHTS – (kg)						
Wheelbase (WB)		2,525		3,375	2,810	
Overall length (OL)		4,765		6,120	5,435	
Overall width (OW)		1,880			2,135	
Cab width		1,695			1,995	
Overall height (OH)		2,300			2,460	
Front Overhang (FOH)		980			1,115	
Road Clearance (RC)		170				
Front Track (FT)		1,400			1,655	
Rear Track (RT)		1,435			1,480	
Turning circle	Kerb to Kerb	9,600		12,600	9,800	
	Wall to Wall	10,800		13,800	11,200	
Indicative chassis mass – kg (STD tools, 10 litres of fuel, spare tyre & subject to a +/- 3% tolerance)						
Total		2,234	2,269	2,366	2,495	2,525
Front		1,409	1,424	1,476	1,618	1,638
Rear		830	845	890	877	887
Standard Ratings	GVM	4,499				
	GCM	7,999				
Optional Ratings	GVM	5,500				
	GCM	9,000	8,000		9,000	8,000

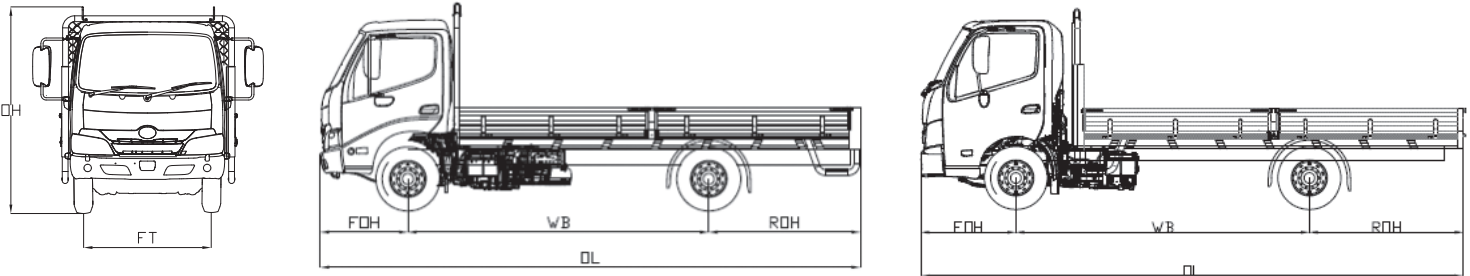

Drawings are for reference only to the dimensions table above.

## MODEL DETAILS

Model Description		617 MT 3430 Wide ALLOY TRAY	616 AT 3430 Wide ALLOY TRAY	721 AT 3500 Wide ALLOY TRAY	616 AT 3870 Wide CREW ALLOY TRAY	721 AT 4400 Wide CREW ALLOY TRAY
Product Code		XZU710R-WKFMTQ3 AL	XZU710R-WKTMSQ3 AL	XJC710R-WKTQJQ3 AL	XZU720R-ZKTMSQ3 AL	XJC740R-ZKTQJQ3 AL
ALLOY TRAY BODY DETAILS						
Internal length		4,435			4,135	4,435
Internal width		2,055		2,220	2,055	2,220
Floor rating		4 tonnes		6 tonnes	4 tonnes	6 tonnes
Rope rails		40 x 3 mm				
Drop sides per side		2				
Height of Drop sides & tailgate		365 mm				
VEHICLE DETAILS						
Engine speed @ 100 Km/h		2,128rpm	2,165rpm	1,994rpm	2,165rpm	1,994rpm
Max theoretical speed		145km/h	143km/h	133 km/h	143km/h	133 km/h
Engine Power & Torque (HP & Nm)		165hp/464Nm	150hp/420Nm	205hp/600Nm	150hp/420Nm	205hp/600Nm
Transmission type & number of forward gears		Manual 6 speed	Automatic 6 speed			
Fuel Tank Capacity		150 L		200 L	100 L	200 L
Wheels & Tyres		195/85R16		225/80R17.5	195/85R16	225/80R17.5
Seating capacity		3			7	
DIMENSIONS – (MM)/WEIGHTS – (kg)						
Wheelbase (WB)		3,430		3,500	3,870	4,400
Overall length (OL)		6,335		6,380	7,150	7,385
Overall width (OW)		2,135		2,300	2,135	2,300
Cab width		1,995				
Overall height (OH)		2,460		2,640	2,460	2,640
Front Overhang (FOH)		1,115				
Road Clearance (RC)		170		215	170	215
Front Track (FT)		1,655				
Rear Track (RT)		1,480		1,660	1,480	1,660
Turning circle	Kerb to Kerb	11,800		12,600	13,000	15,600
	Wall to Wall	13,200		14,000	14,400	17,000
Indicative chassis mass – kg (STD tools, 10 litres of fuel, spare tyre & subject to a +/- 3% tolerance)						
Total		2,576	2,601	3,058	2,850	3,358
Front		1,626	1,646	1,906	1,767	2,080
Rear		950	955	1,152	1,083	1,278
Standard Ratings	GVM	4,499		6,500	4,499	6,500
	GCM	7,999		10,000	7,999	10,000
Optional Ratings	GVM	5,500		4,499	5,500	–
	GCM	9,000	8,000	7,999	8,000	–

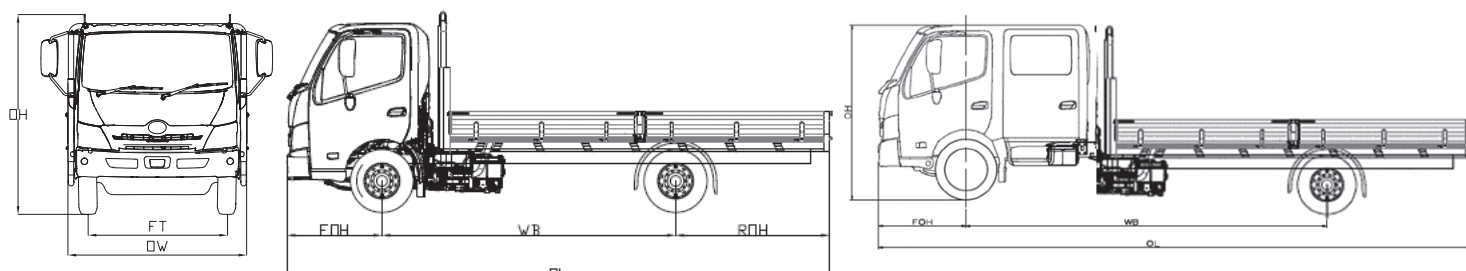

For specific layouts please refer to the applicable body mounting manual. (BMM)

## Alloy Tray Range

### SAFETY FEATURES

Active Safety Features		
Vehicle Stability Control	VSC	Equipped
Anti-lock Brakes System	ABS	Equipped
Pre-Collision System	PCS	Equipped
PCS is inclusive of	Autonomous Emergency Braking	AEB
	Pedestrian Detection	PD
Traction Control	TC	Equipped
Lane Departure Warning System	LDWS	Equipped
Reverse Camera	RC	Equipped
ES Start (MT models only)	ES	Equipped
Daytime Running Lamps	DRL	Equipped
Reverse Buzzer		Equipped
Passive Safety Features		
ECE-R29 Cab Strength Certification		Equipped
SRS airbags for driver & side passenger		Equipped
SRS seatbelt pretensioner for driver & side passenger		Equipped
Shock absorbing & collapsible steering column		Equipped
Door Beams (anti side intrusion)		Equipped

### BODY FEATURES

Aluminium construction
Rope rails
Drop sides & tail gate
Front side steps left & right

### GENUINE ACCESSORY OPTIONS

Bullbar or Nudge bar
Chrome wheel covers
Cameras (up to additional 5 extra)
Dash & Floor mats
Lane Change Assist Cameras
Truck spec GPS navigation with live traffic
Seat covers (Wool, Canvas, Carbon)
Stone guard
Weathershields
Body internal tie down "I" bolts
Ladder racks
UHF CB Radio kit
Please check with your dealer for availability, price & fitment

For Cab Chassis related specifications not included in this document please refer to the applicable Cab Chassis spec sheet or Body mounting Manual

### WARRANTY

New vehicle warranty period

Light Duty Model	Axle configuration	Standard warranty (whichever comes first)	Cab corrosion perforation
300 Series	4 x 2	5 years or 250,000km	60 months

Battery warranty – 12 months from date of delivery  
\* For conditions, refer to the Hino Parts & Service warranty brochure

Genuine parts or accessories warranty – 3 years unlimited kilometres when fitted by an authorised Hino dealer \*  
Built to Go Body warranty – 5 years or 250,000km (whichever comes first)



### DISCLAIMER

Important notice – Hino Trucks are distributed in Australia by Hino Motor Sales Australia Pty Ltd A C N 064 989 724. All efforts have been made to ensure the information contained in this brochure was correct at time of printing or uploading. Hino Motor Sales Australia Pty Ltd reserves the right to alter any details of the specifications and equipment without notice. Hino in so far as it is permitted by law to do so, shall not be liable in any way as a result of any reliance placed by any person on anything contained in this brochure. You should therefore check with your authorised Hino dealer at the time of ordering your motor vehicle to ensure that colour, specifications, equipment, design features and options are available for the vehicle you are ordering. Please note that some options may only be available in combination with others. Authorised Hino dealers will on request provide up to date information on all accessories, design features, prices & availability. \*\*Maximum Cruise control setting 106 km/h. \*\*\* GVM ratings of 4,499kg are conditional that the ADR definition of a "Goods Vehicle" can be met.